



**NOTES**

- - - Highway Boundary
- Highway Verge
- Highway Footway
- Highway Carriageway

|     |                                       |    |     |     |        |
|-----|---------------------------------------|----|-----|-----|--------|
| A   | Draft stamp removed & Scale Bar added | DH | SW  | SW  | Jun 21 |
| Rev | Amendments                            | Dm | CHK | App | Date   |

**Charles & Associates**

Issued by

Landmark House  
 Station Road  
 Hook  
 Hampshire  
 RG27 9PL  
 01256 336328

Park House  
 Park Farm  
 East Malling Trust Estate  
 Badbourne Lane  
 Aylesford  
 Kent  
 ME20 6SN  
 01732 448128

enquiries@c-a.co.uk  
www.c-a.co.uk

|   |            |          |
|---|------------|----------|
| Job Title   |            |          |
| <b>Hempstead Valley,<br/>Medway</b>                                       |            |          |
| Drawing Title   |            |          |
| <b>Walderslade Road/Princes Avenue<br/>Proposed Roundabout Mitigation</b> |            |          |
| Client  |            |          |
| <b>K. Attwood</b>   |            |          |
| Scale   | Date       | Designed |
| 1:200 @ A1  | Mar 19     | RA       |
| Drawn   | Checked    | Approved |
| RA  | SW         | JW       |
| Job No  | Drawing No | Rev      |
| 17-035  | 17-035-021 | A        |

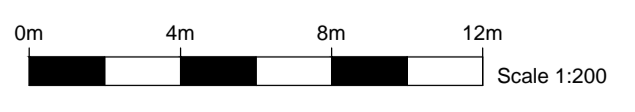



NOTES

- Highway Boundary
- Highway Verge
- Highway Footway
- Highway Carriageway

|     |                                       |     |     |        |
|-----|---------------------------------------|-----|-----|--------|
| A   | Draft stamp removed & Scale Bar added | DH  | SW  | Jun 21 |
| Rev | Amendments                            | Drn | Chk | App    |

**Charles & Associates**

Landmark House  
Station Road  
Hampshire  
RG27 9HA  
01256 42429

Issued by

Park House  
Park Farm  
East Milling, Trout Gange  
Bradbourne Lane  
Aylesford  
Kent  
ME20 6SN  
01732 448128

enquiries@ca.co.uk  
www.c-a.co.uk

Job Title  
**Hempstead Valley, Medway**

Drawing Title  
**St End Rd/Capstone Rd/Luton High St  
Proposed Roundabout Mitigation**

Client  
**K. Attwood**

|                            |                                 |                       |
|----------------------------|---------------------------------|-----------------------|
| Scale<br><b>1:200 @ A1</b> | Date<br><b>Mar 19</b>           | Designed<br><b>RA</b> |
| Drawn<br><b>RA</b>         | Checked<br><b>SW</b>            | Approved<br><b>JW</b> |
| Job No<br><b>17-035</b>    | Drawing No<br><b>17-035-022</b> | Rev<br><b>A</b>       |

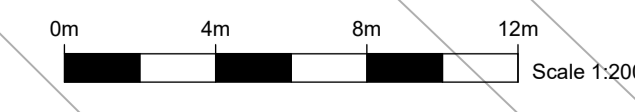



**PROPOSED SIGNALISED JUNCTION ARRANGEMENT - 1:250**

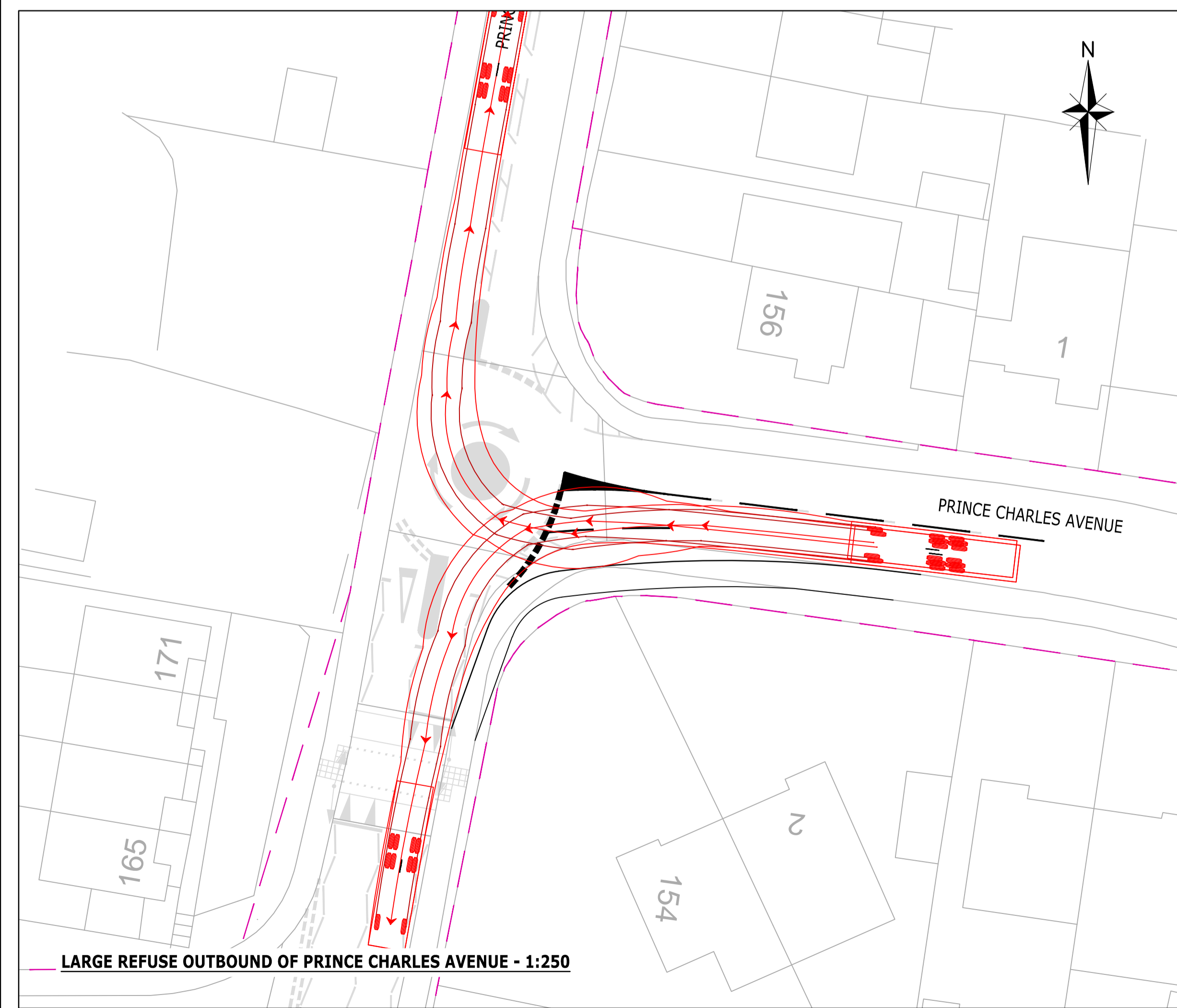

**LARGE REFUSE OUTBOUND OF PRINCE CHARLES AVENUE - 1:250**

**NOTES**

--- HIGHWAY BOUNDARY

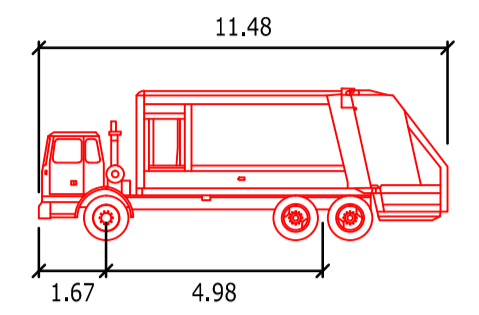

**KCC Refuse Vehicle**  
 meters  
 Width : 2.55  
 Track : 2.15  
 Lock to Lock Time : 6.0  
 Steering Angle : 31.8

**DRAFT**

|     |  |    |     |     |        |
|-----|--|----|-----|-----|--------|
| 0   | Lane widths amended to accommodate right turners | DH | SW  | JW  | Mar 20 |
| Rev | Amendments                                       | Dm | Chk | App | Date   |

**Charles & Associates**

based by

Landmark House  
 Station Road  
 Hook  
 Hampshire  
 RG27 9HA  
 01256 628428  
 www.c-a.co.uk

Park House  
 Park Farm  
 East Mallard Trust Estate  
 Redbourne Lane  
 Aylesford  
 Kent  
 ME20 6SN  
 01732 448120

**Hempstead Valley, Medway**

Drawing Title  
**Proposed Mini-Roundabout Princes Ave/Prince Charles Ave**

Client  
**Hume Planning Consultancy**

|        |            |            |            |          |    |
|--------|------------|------------|------------|----------|----|
| Scale  | 1:250 @ A1 | Date       | Jan 2020   | Designed | DH |
| Drawn  | DH         | Checked    | SW         | Approved | JW |
| Job No | 17-035     | Drawing No | 17-035-029 | Rev      | 0  |

## Figures

Figure 3.1 - 2025 Reference Case Vs  
WithDev Scenario 2 AM Assigned Volumes  
Capstone Valley north

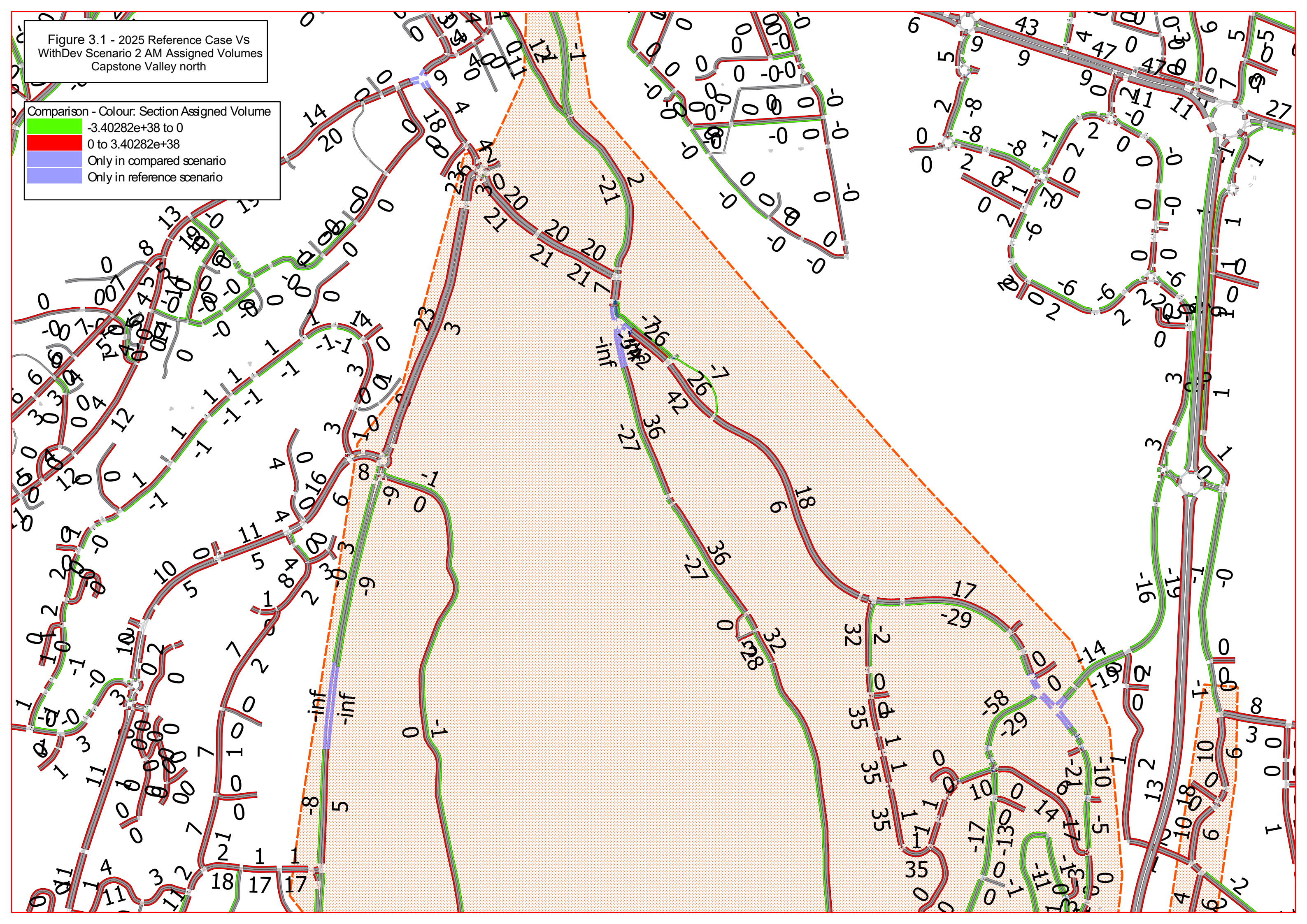
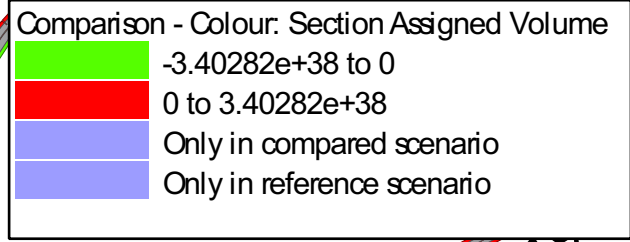

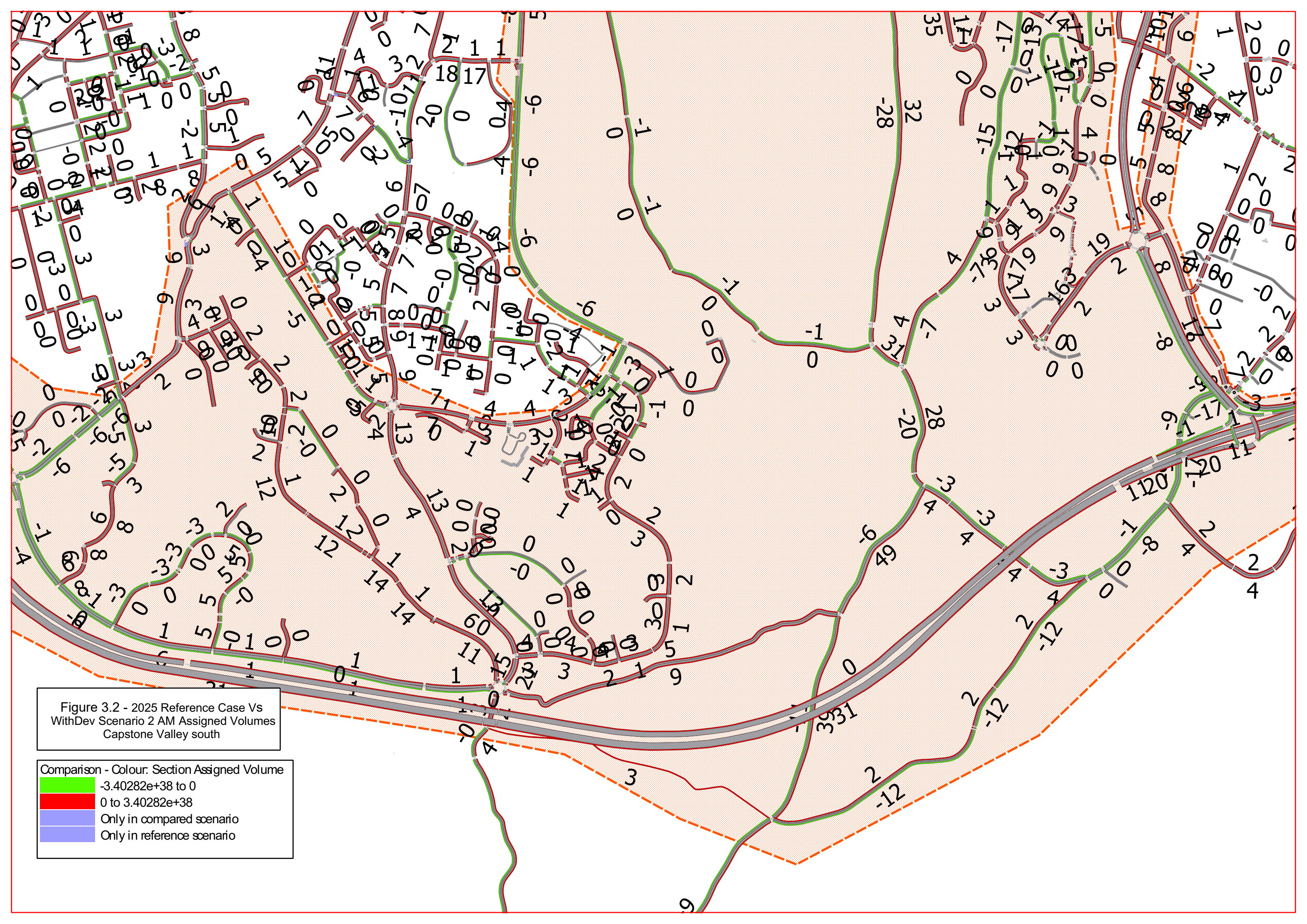
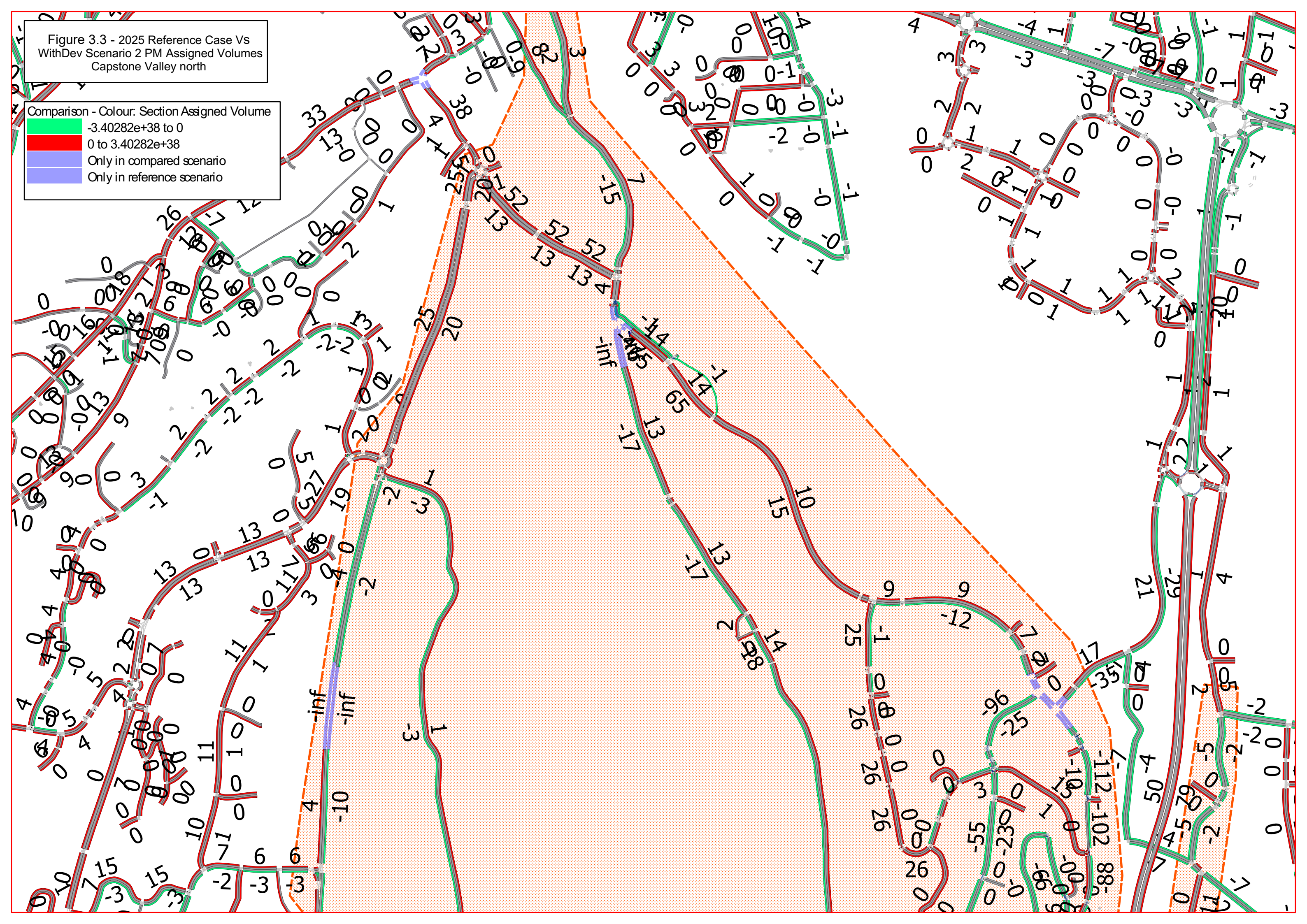
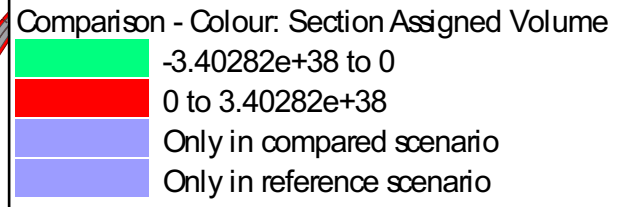

Figure 3.2 - 2025 Reference Case Vs WithDev Scenario 2 AM Assigned Volumes Capstone Valley south

Comparison - Colour: Section Assigned Volume

- $-3.40282 \times 10^{38}$  to 0
- 0 to  $3.40282 \times 10^{38}$
- Only in compared scenario
- Only in reference scenario

Figure 3.3 - 2025 Reference Case Vs  
WithDev Scenario 2 PM Assigned Volumes  
Capstone Valley north



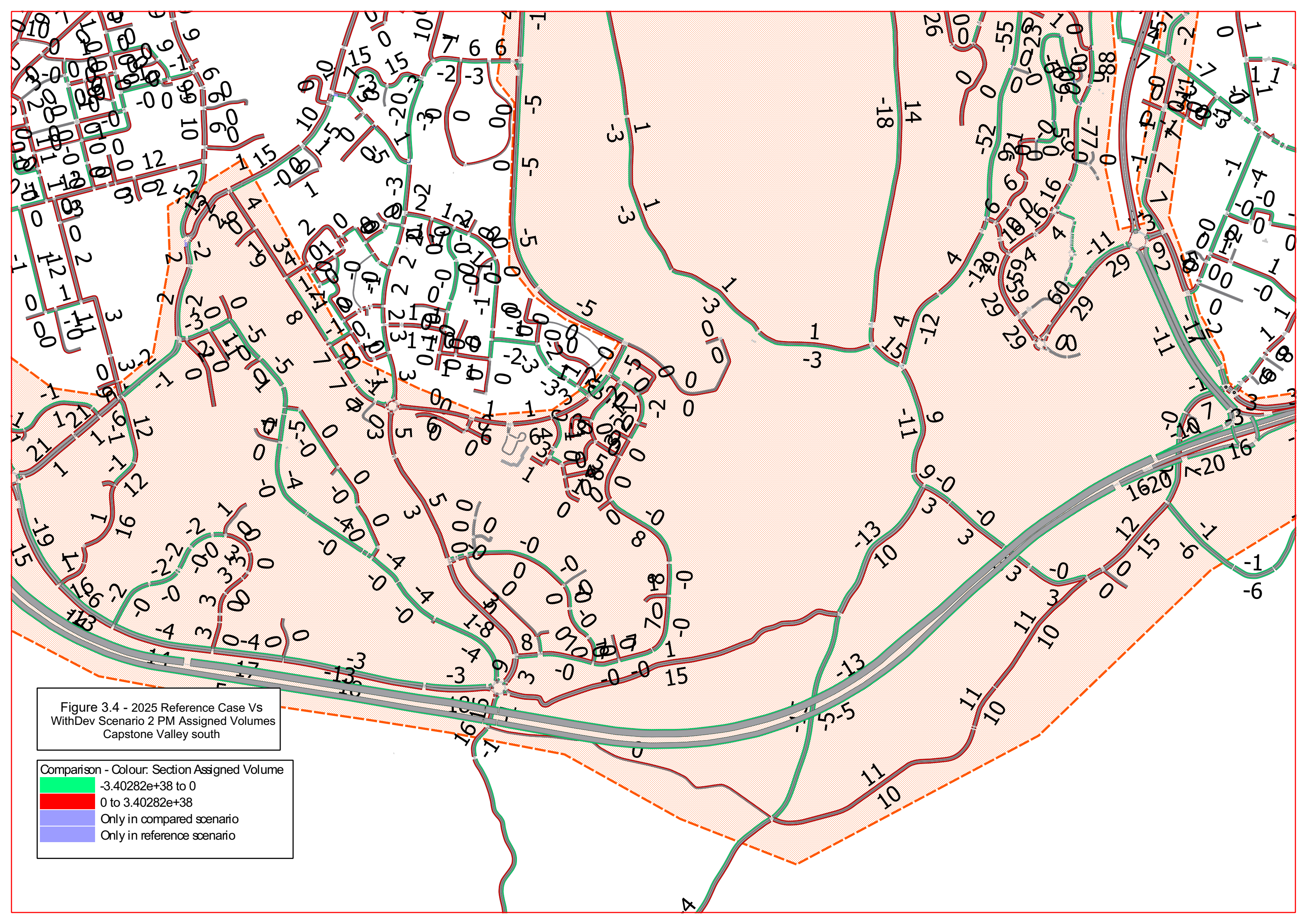

Figure 3.4 - 2025 Reference Case Vs WithDev Scenario 2 PM Assigned Volumes Capstone Valley south

Comparison - Colour: Section Assigned Volume

|  |                            |
|--|----------------------------|
|  | -3.40282e+38 to 0          |
|  | 0 to 3.40282e+38           |
|  | Only in compared scenario  |
|  | Only in reference scenario |



## Appendix A Microsimulation Output Tables