



Exciting Development Opportunity for Three, 2-bed Dwellings near Crowborough High Street. We understand the Site benefits from a Resolution to grant Planning Subject to the Signing of a Section 106

Land at and to the West of Heatherbank, The Broadway, Crowborough, TN6 1DE

# Site Description

All photographs, graphics and plans are for illustrative purposes only and all measurements are approximate

The site is located in central Crowborough and fronts Croft Road, as well as Crowborough High Street. The site currently houses three buildings, two retail units which face the high street. It is the Vendor's intention to retain these two units. The third building is set behind the street frontage and is used as a workshop, offices and garaging.

The balance of the site is used for informal parking with a redundant area of scrub/grassland at the western end. Vehicle access to the parking area is from Croft Road via the shared drive/pedestrian footpath which connects the High Street and the municipal car park to the west. The site slopes from the car park to Croft Road.

Crowborough is an attractive town situated on the edge of the Ashdown Forest and located within the leafy borough of East Sussex. It was also once the home of the famous author Sir Arthur Conan Doyle. Though located in East Sussex, Crowborough is also conveniently positioned close to the Kentish border.

The High Street, B2100 connects to Beacon Road, A26 (north of the site) which is a primary vehicle route in and out of Crowborough town. The A26 connects Crowborough to Tunbridge Wells, and Tonbridge in the North-Eastern direction, and Newhaven on the coast, via Uckfield and Lewes in the Southern direction.

Crowborough offers A wide range of amenities, schools and shops, including a Waitrose and a leisure centre with swimming pool and squash courts. The train station, which is located at the southern end of the High Street, is part of the Oxted Line, providing direct services to London. With travel to London Bridge taking from 69 minutes.

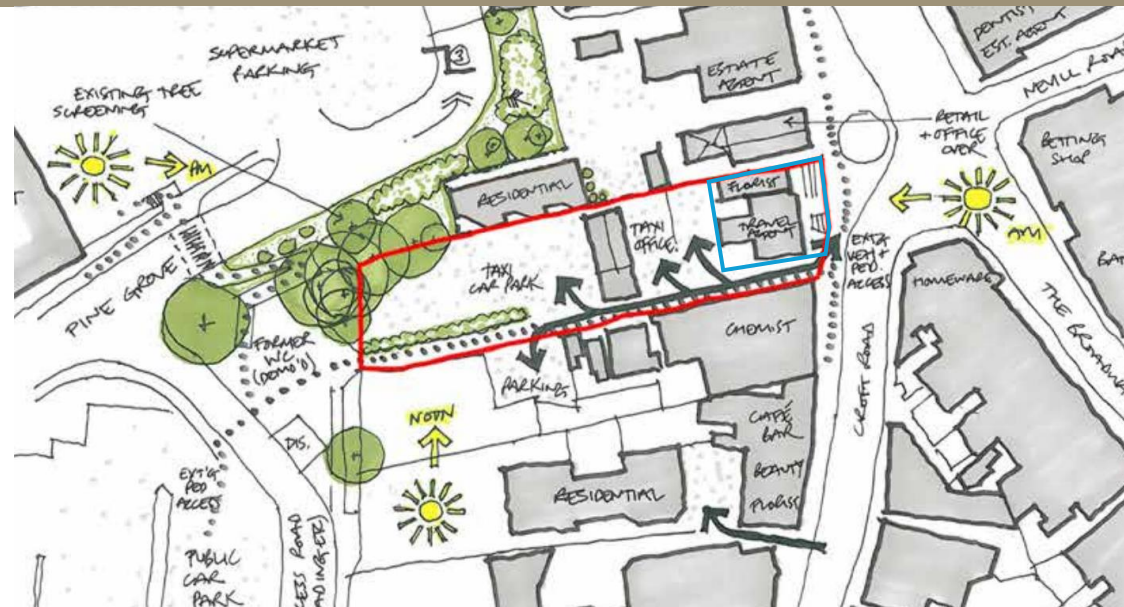

# Planning

All photographs, graphics and plans are for illustrative purposes only and all measurements are approximate

We understand that the site benefits from a resolution to grant planning subject to signing the S106. With the Planning Ref: [WD/2023/1712/F](#) for the: Redevelopment of site comprising the demolition of existing two-storey building and erection of 3 no. Two-bedroom dwellings, with parking, landscaping and public realm improvement works.

The Vendors believe that the site may have the potential for a fourth dwelling, subject to all the necessary consents.



# Sales and Viewing Information

All photographs, graphics and plans are for illustrative purposes only and all measurements are approximate

## Agent's Note

- 1) The Vendor is to retain the two retail units that face the High Street.
- 2) We understand that the site is currently subject to a Lease, which is outside the Landlord and Tenant Act 1954.

## Services

All intending purchasers are strongly advised to make their own enquiries with the relevant statutory undertakers to ensure availability and adequacy of any services.

## Tenure

The site is to be sold Freehold with vacant possession on Completion.

## VAT

The Vendor has elected not to charge VAT.

## CIL/S106

TBC

## Method of Sale

Offers are invited by way of private treaty. All bids must be submitted in writing to RPC's Tonbridge Office. [p.bowden@rpcland.co.uk](mailto:p.bowden@rpcland.co.uk)

In submitting a proposal please include the following

- Offer price
- Details of any assumptions and conditions, including any abnormal costs.
- Due diligence already undertaken, including confirmation of reviewing the website information
- Due diligence required prior to exchange of contracts along with associated timeframe.
- Confirmation of exchange and completion timescales.
- Confirmation of purchasing entity, including full contact details.
- Board approval status or required process.
- confirmation of funds, (including Bank./Loan confirmation if required.)
- Full solicitor's details
- Previous track record of similar purchases.
- *Details of any overage which may be paid in light of improved planning consents*

The Vendor reserves the right not to accept the highest nor any bid made for the site.

As a regulated industry under anti-money laundering regulations RPC Land & New Homes will need to verify the identity of the purchasers and this will be completed before Heads of Terms are issued.

## Viewing

Strictly by appointment with RPC Land & New Homes, Tonbridge office 01732 363633.

## Fees

We have agreed with the Vendor that the Purchaser will be responsible for RPC Land & New Homes fees at 2% of the purchase price plus V.A.T at the prevailing rate, this should be taken into consideration when making offers.

# Agent Details

All photographs, graphics and plans are for illustrative purposes only and all measurements are approximate

Peter Bowden

01732 363633

[p.bowden@rpcland.co.uk](mailto:p.bowden@rpcland.co.uk)



## Misrepresentation Clause

RPC Land & New Homes for themselves and for the vendors of this property for whom they act, give notice that:

These particulars are prepared only for the guidance of prospective purchasers. They are intended to give a fair overall description of the property but do not constitute the whole or any part of an offer or contract. RPC Land & New Homes undertake to comply with the terms of the Property Misdescriptions Act 1991 but prospective purchasers must satisfy themselves as to the accuracy of the contents of these particulars, and RPC Land & New Homes will not be liable in negligence for any loss arising from the use of these particulars.

Any information contained herein (whether in the text, plans or photographs) is given in good faith but RPC Land & New Homes cannot guarantee the accuracy of any description, dimensions, references to condition, necessary permissions for use and occupation or any other details contained therein, nor should any information contained herein be relied upon as a statement or representation of fact. Prospective purchasers or tenants must satisfy themselves as to the accuracy of all information contained in these particulars.

Prices and rents quoted in these particulars may be subject to VAT in addition.

Nothing in these particulars shall be deemed to be a statement that the property is in good condition or otherwise, and reference to any plant, machinery, equipment, services, fixtures or fittings at the property shall not constitute a representation as to its state or condition or that it is capable of fulfilling its intended function. Prospective purchasers should satisfy themselves as to the fitness of such items for their requirements.

The photographs appearing in this brochure show only certain parts and aspects of the property. Certain aspects of the property may have changed since the photographs were taken and it should not be assumed that the property remains precisely as displayed in the photographs. It should not be assumed that everything shown in the photographs is included in the sale of the property. Furthermore no assumptions should be made in respect of parts of the property which are not shown in the photographs.

Any reference in these particulars to the fact that alterations have been carried out or that a particular use is made of any part of the property is not intended to be a statement that any necessary planning, building regulations or other consents have been obtained and these matters must be verified by any intending purchaser.

No employee of RPC Land & New Homes has any authority to make or give any representation or warranty whatsoever in relation to the property.