

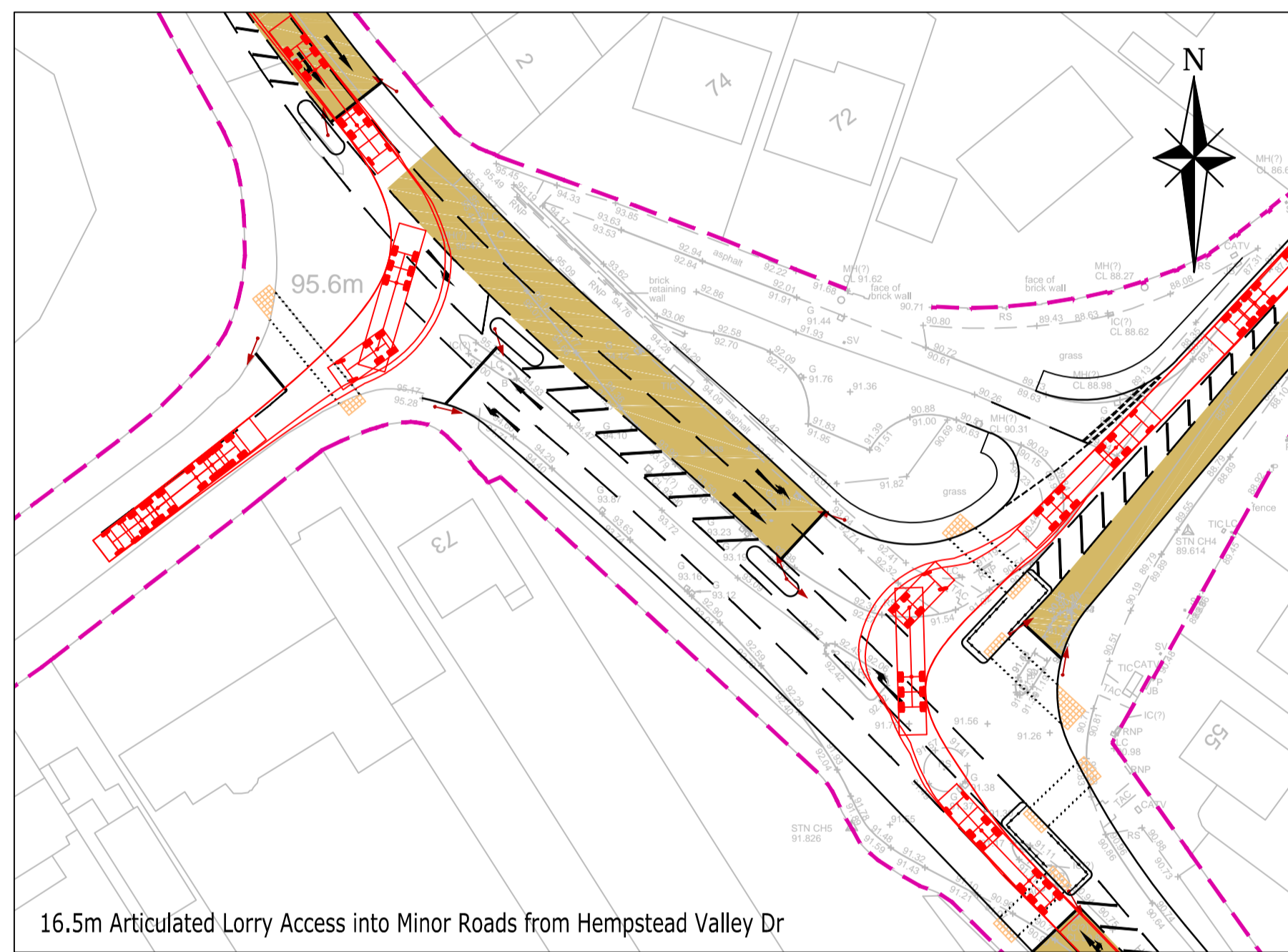

16.5m Articulated Lorry Access & Egress into Hempstead Road (North)



16.5m Articulated Lorry Access into Minor Roads from Hempstead Valley Dr



16.5m Articulated Lorry Access & Egress using Minor Roads

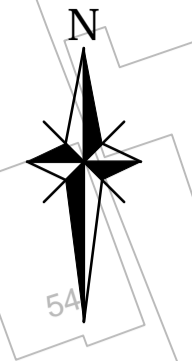
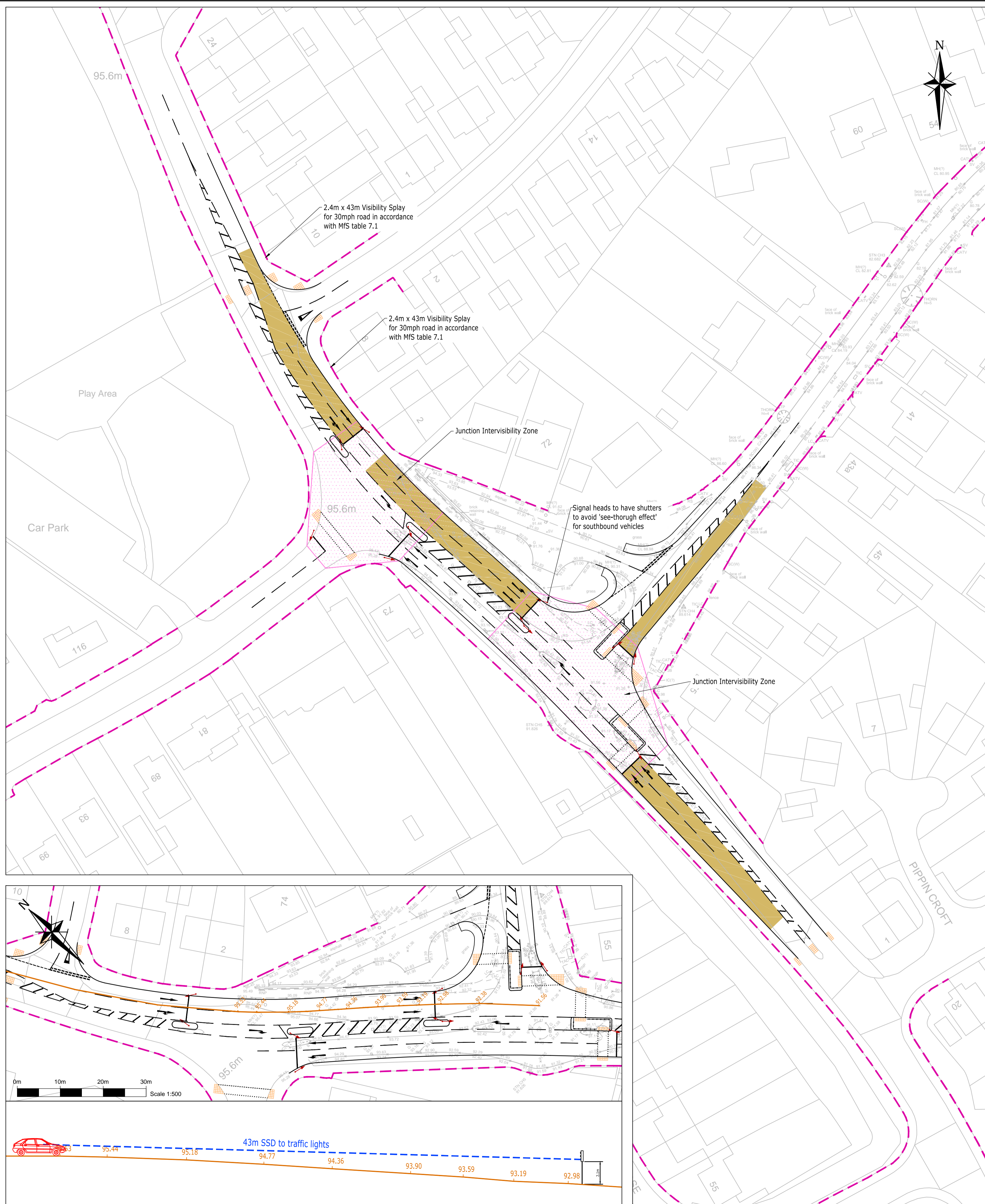

NOTES

- Highway Boundary
 - High Friction Surfacing
-
- Max Legal Articulated Vehicle (16.5m)
 - Overall Length 16.500m
 - Overall Width 2.500m
 - Overall Body Height 3.632m
 - Min Body Ground Clearance 0.396m
 - Max Track Width 2.500m
 - Lock to Lock Time 6.00 sec
 - Kerb to Kerb Turning Radius 6.870m

DRAFT

Rev	Amendments	Dr	SW	Nov 20
A	SSD check & anti skid surfacing added	DH	SW	Nov 20

Charles & Associates

Issued by:

Landmark House
Hampshire
RG27 9HA
01256 49420

Park House
Park Farm
East Mallory Trust Estate
Bosborne Lane
Aylesford
Kent
ME20 6SN
01732 448720

Hempstead Valley, Medway

Hempstead Road, Proposed Signalised Junction

K.Attwood

Scale	Date	Designed
1:500 @ A1	Mar 19	DH
Drawn	Checked	Approved
DH	SW	JW
Job No	Drawing No	Rev
17-035	17-035-020	A

