



No.	Amendments	Drawn	Checked	Appr.	Date



Landed Sheet Issued by Park Show
 Approved East Valley, Free Green
 18/11/19 11:54 AM
 18/11/19 11:54 AM
 18/11/19 11:54 AM
 18/11/19 11:54 AM

Job Title
**Hempstead Valley,
 Medway**

Drawing Title
Link road and site roundabouts

Client
Hume Planning Consultancy

Scale	Date	Designed
1:1,000	Nov 19	GPW
Drawn	Checked	Approved
GPW	JW	JW
Job No	Drawing No	Rev
17-035	17-035/013	

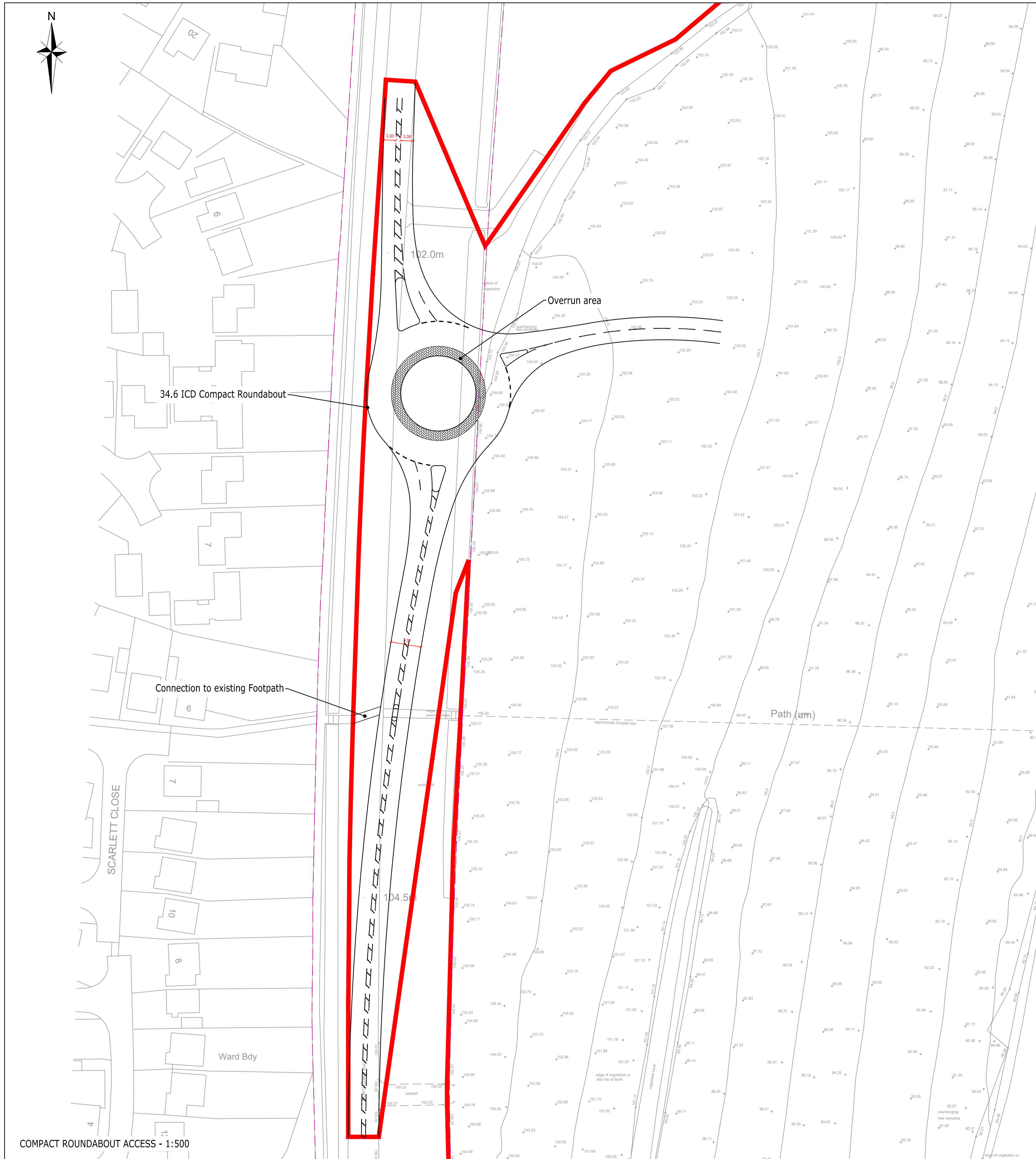
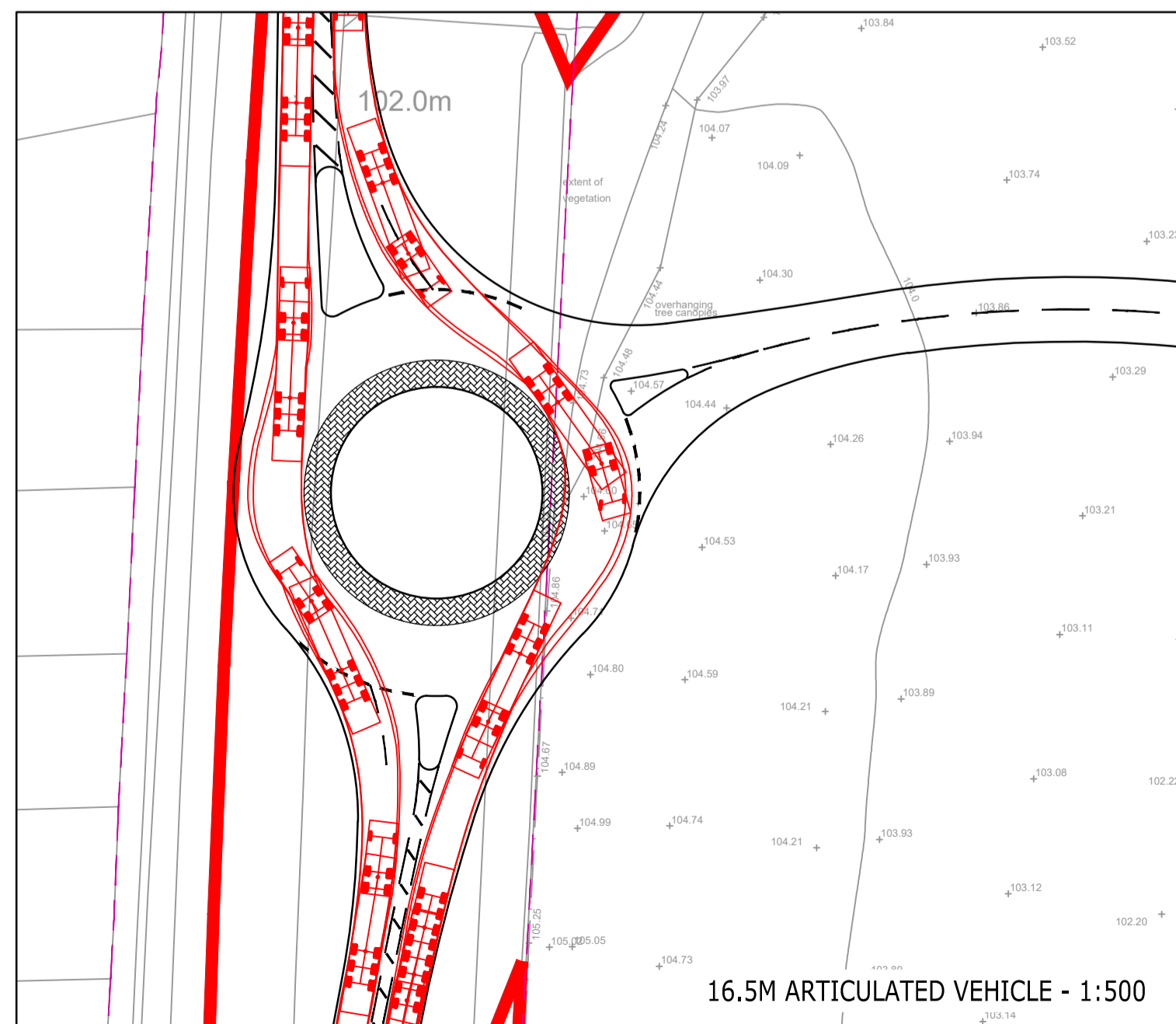
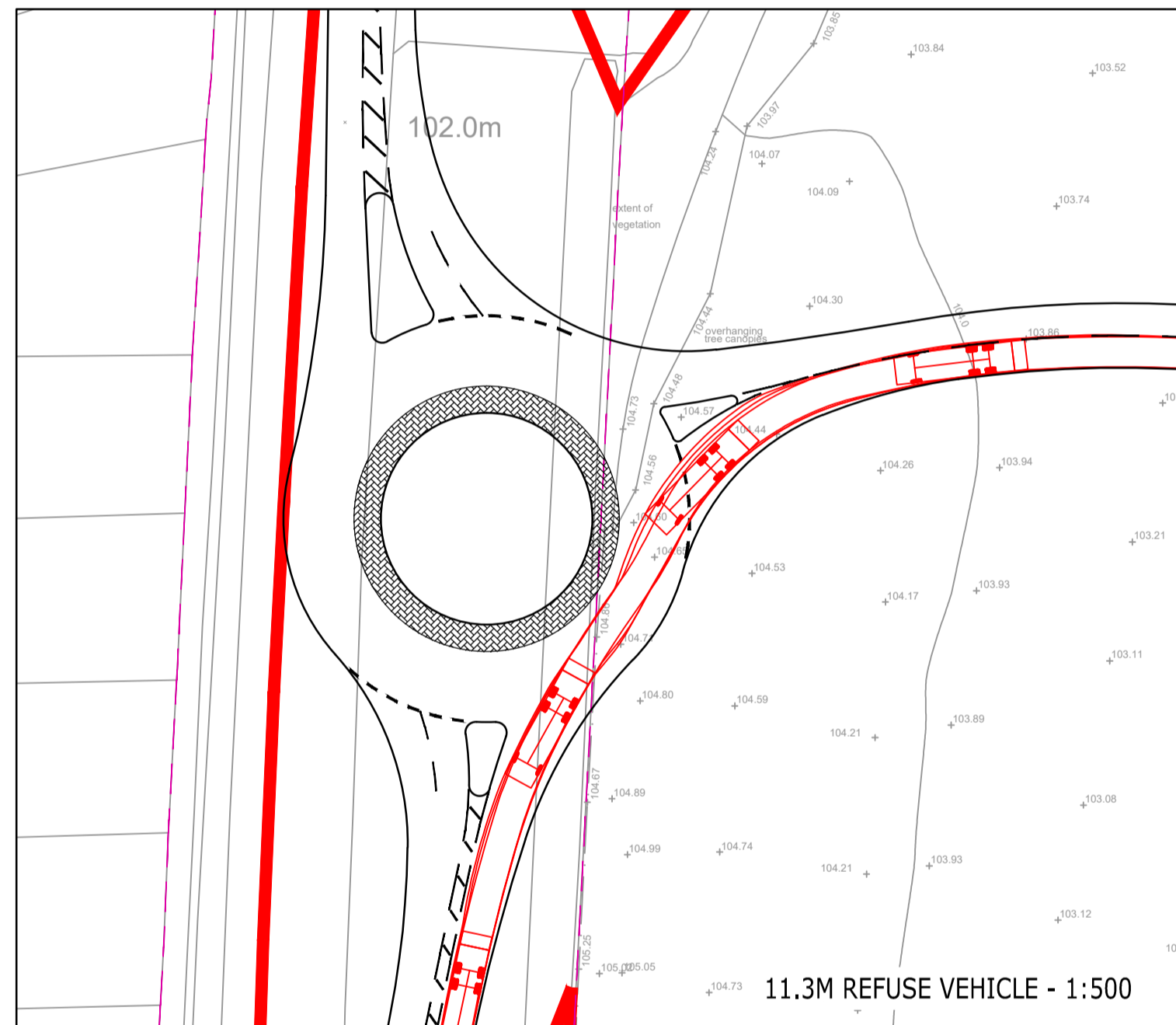
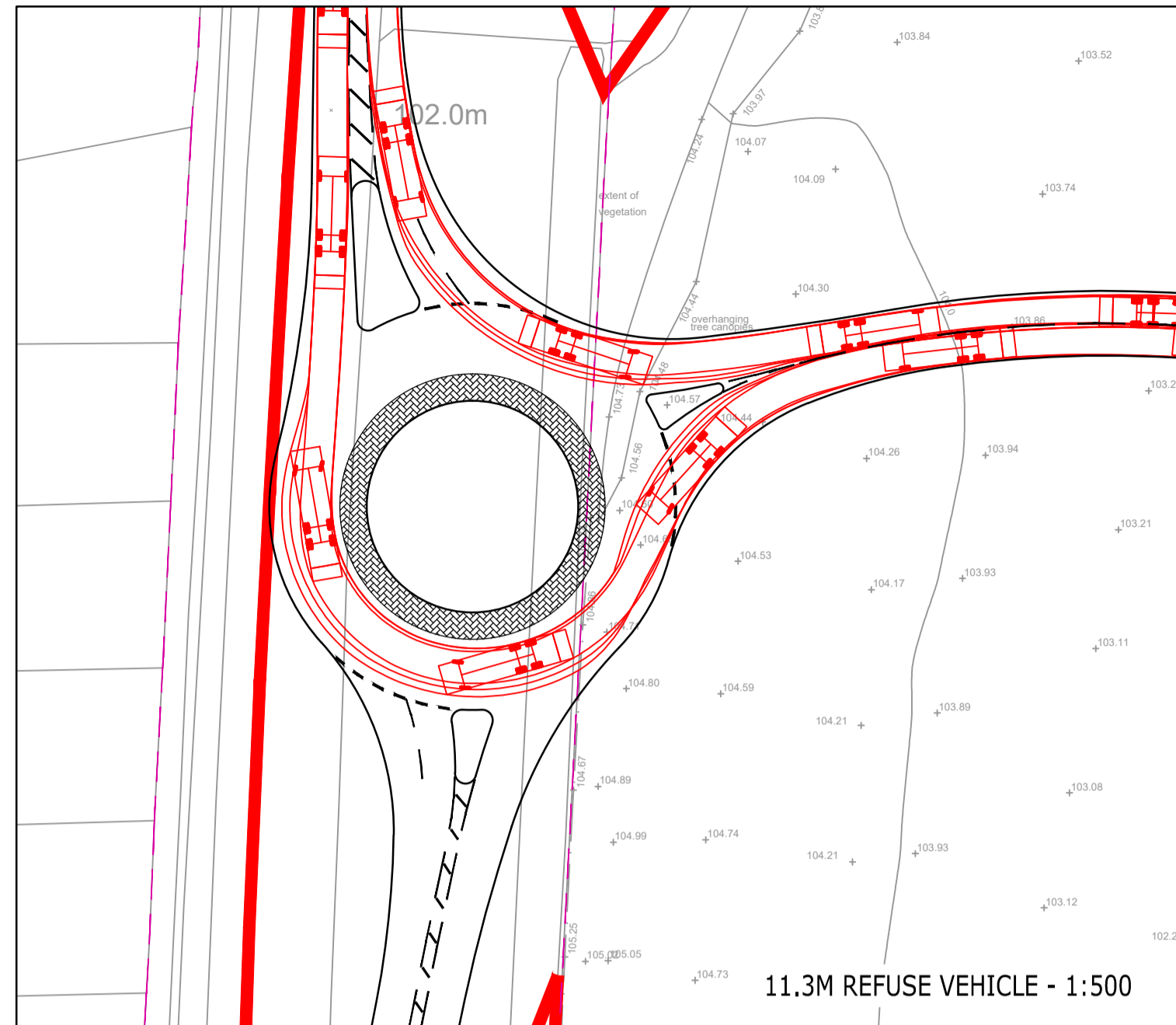

COMPACT ROUNDABOUT ACCESS - 1:500

NOTES

- Highway Boundary
- Site Boundary

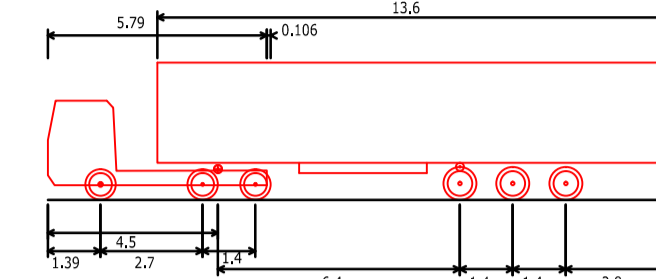

Max Legal Articulated Vehicle (16.5m)
 Overall Length 16.500m
 Overall Width 2.500m
 Overall Body Height 3.632m
 Min Body Ground Clearance 0.396m
 Max Track Width 2.500m
 Lock to Lock Time 6.00 sec
 Kerb to Kerb Turning Radius 6.870m

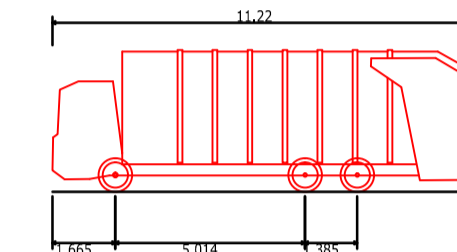

Phoenix 2 Duo Recycler (P2-15W with Elite 6x4 chassis)
 Overall Length 11.220m
 Overall Width 2.530m
 Overall Body Height 3.756m
 Min Body Ground Clearance 0.305m
 Track Width 2.530m
 Lock to Lock Time 4.005
 Kerb to Kerb Turning Radius 11.550m

Key Plan - 1:15k

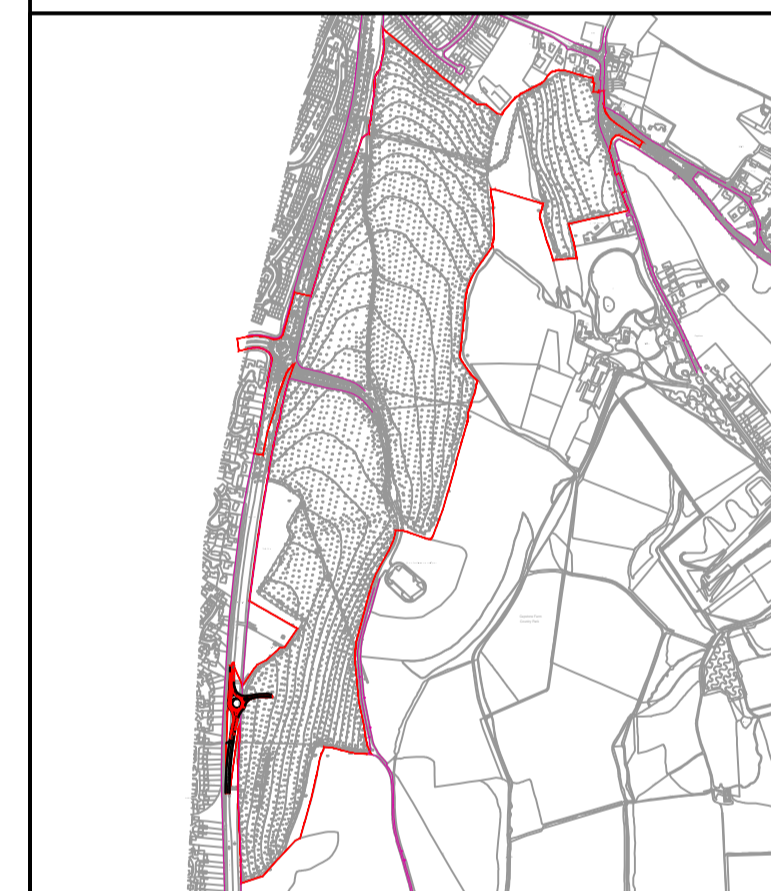

DRAFT

Rev	Amendments	DN	SW	SW	Mar 19
		Chk	App	Date	
A	Eastern arm amended to tie into masterplan				

Charles & Associates

Issued by: []

Landmark Home Station Road
 Hants
 RG27 9HA
 01256 636420

Park House Park Farm
 East Milling Trust Estate
 Brookmore Lane
 Aylesford Kent
 ME20 6SN
 01752 448120

Job Title

Hempstead Valley, Medway

Drawing Title
 Southern Roundabout Access

Client
 Hume Planning Consultancy

Scale	1:500	Date	Feb 19	Designed	DH
Drawn	DH	Checked	SW	Approved	JW
Job No	17-035	Drawing No	17-035-016	Rev	A

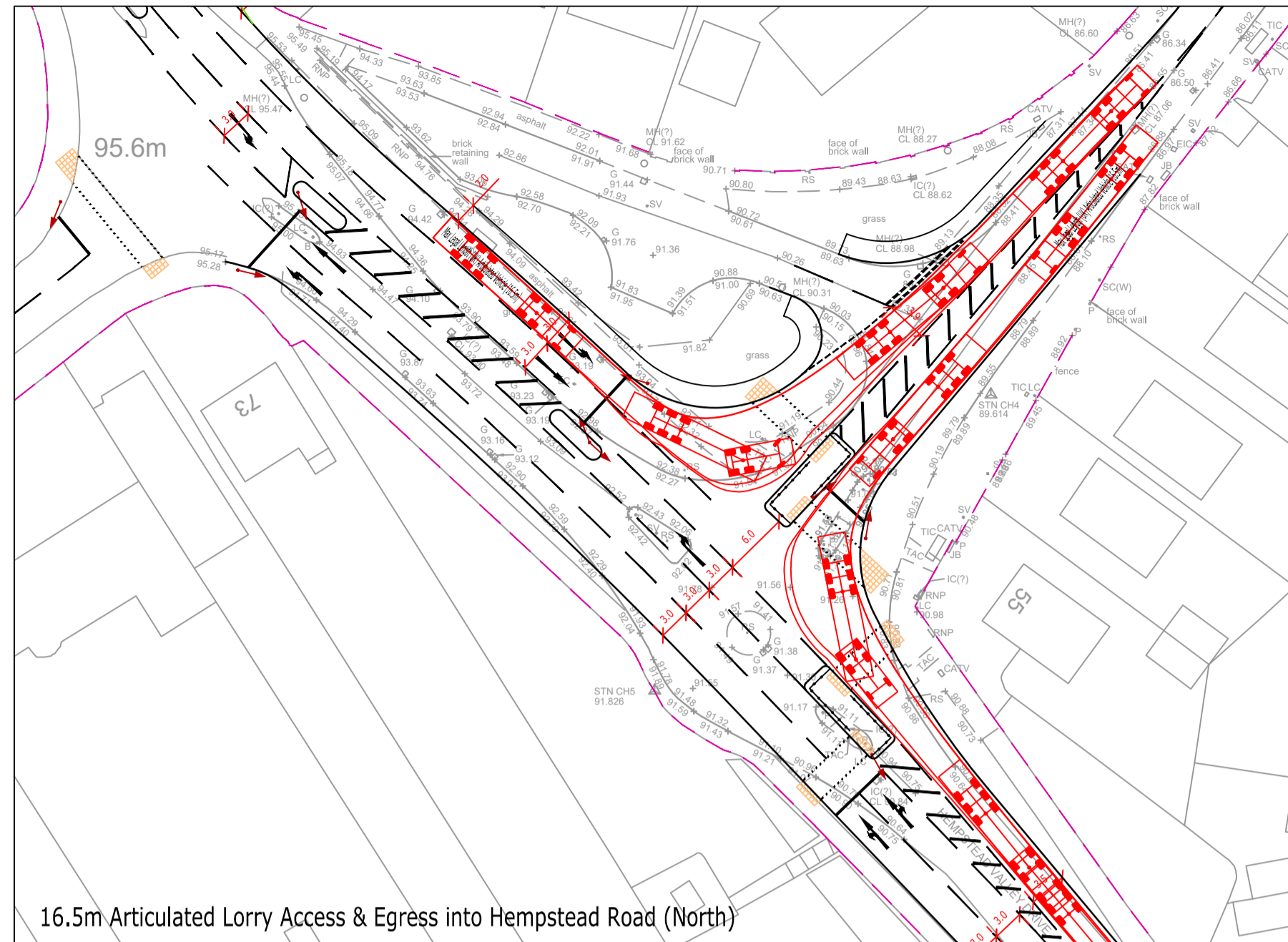

16.5m Articulated Lorry Access & Egress into Hempstead Road (North)

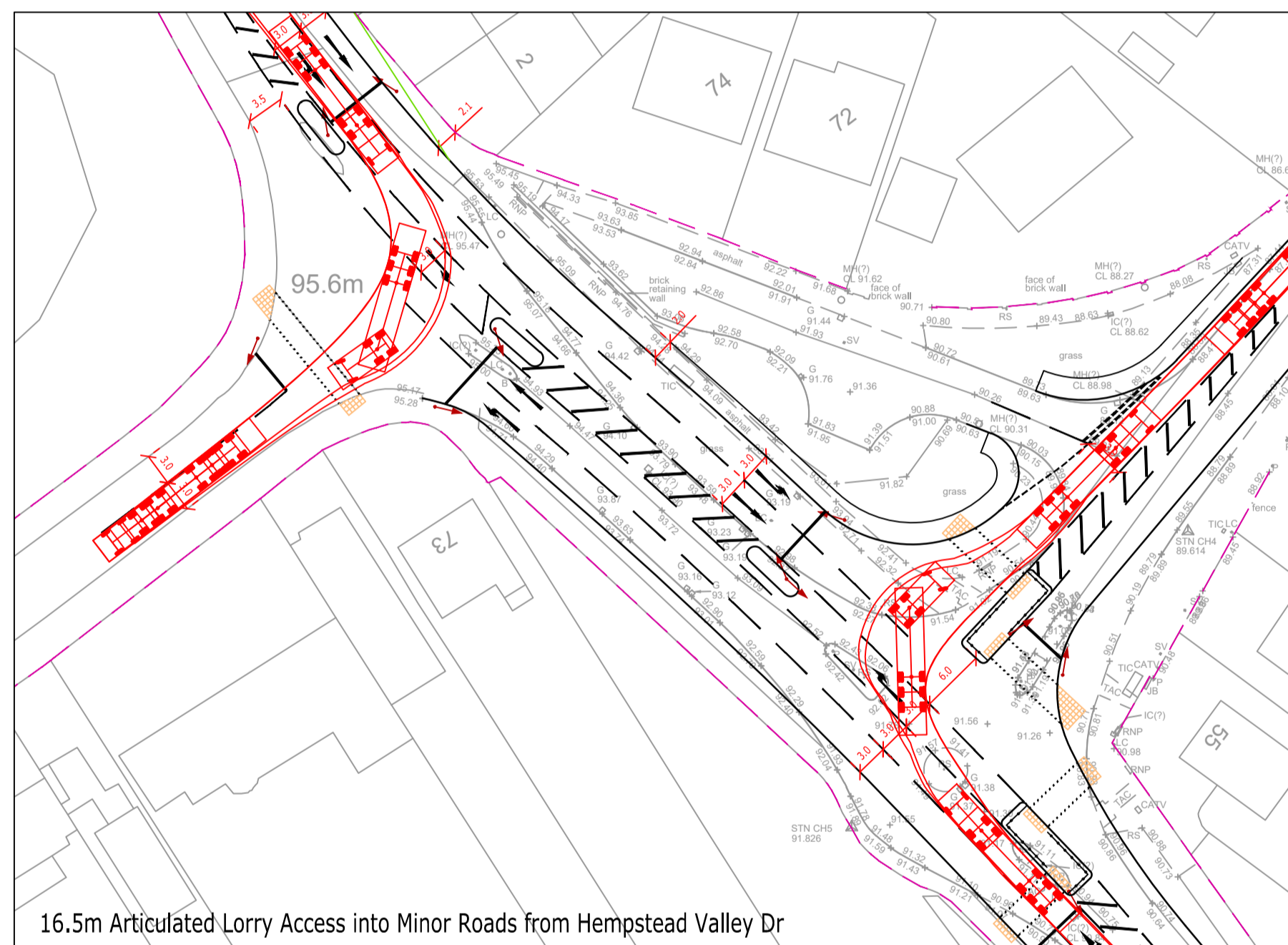

16.5m Articulated Lorry Access into Minor Roads from Hempstead Valley Dr

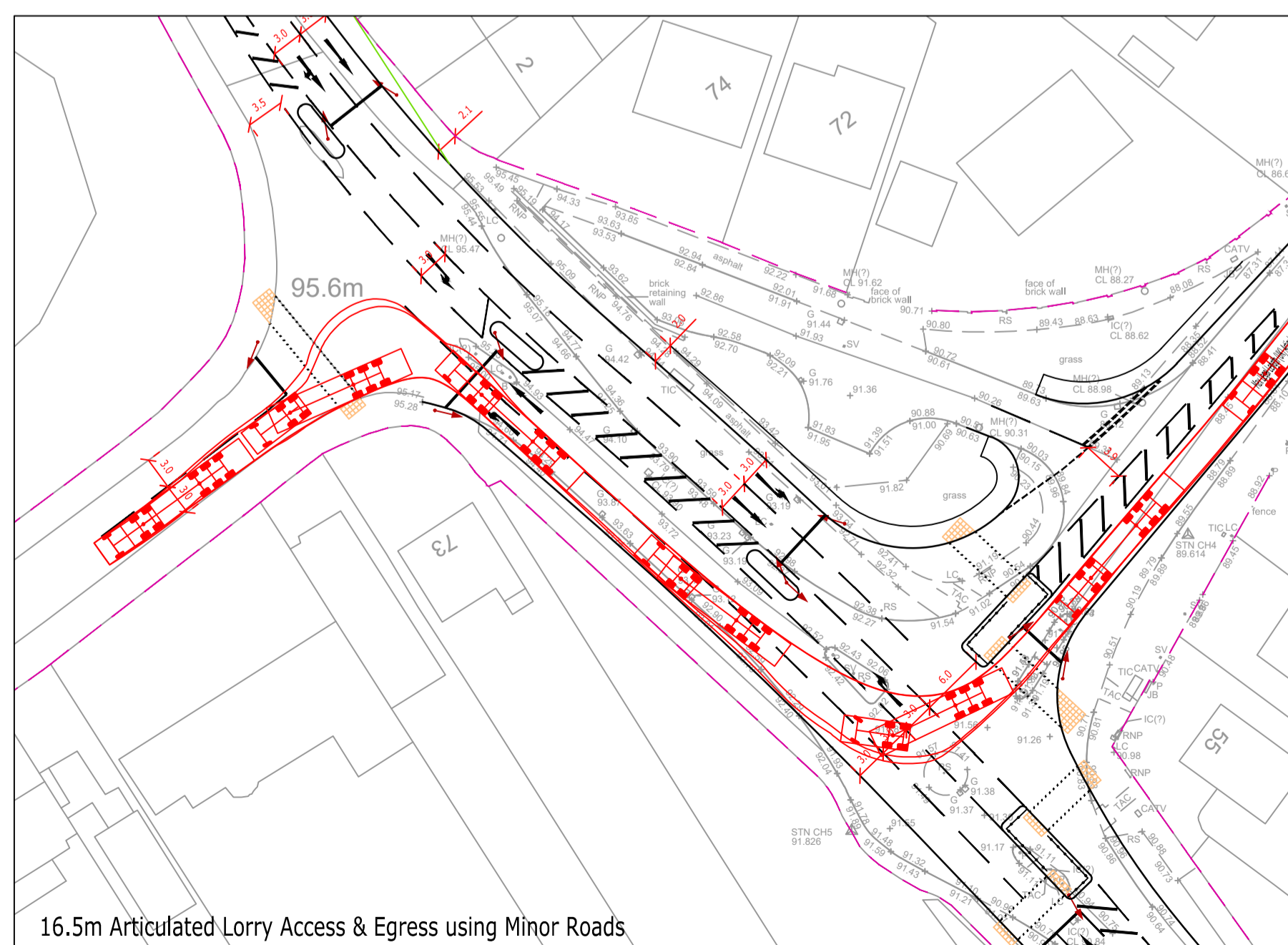

16.5m Articulated Lorry Access & Egress using Minor Roads

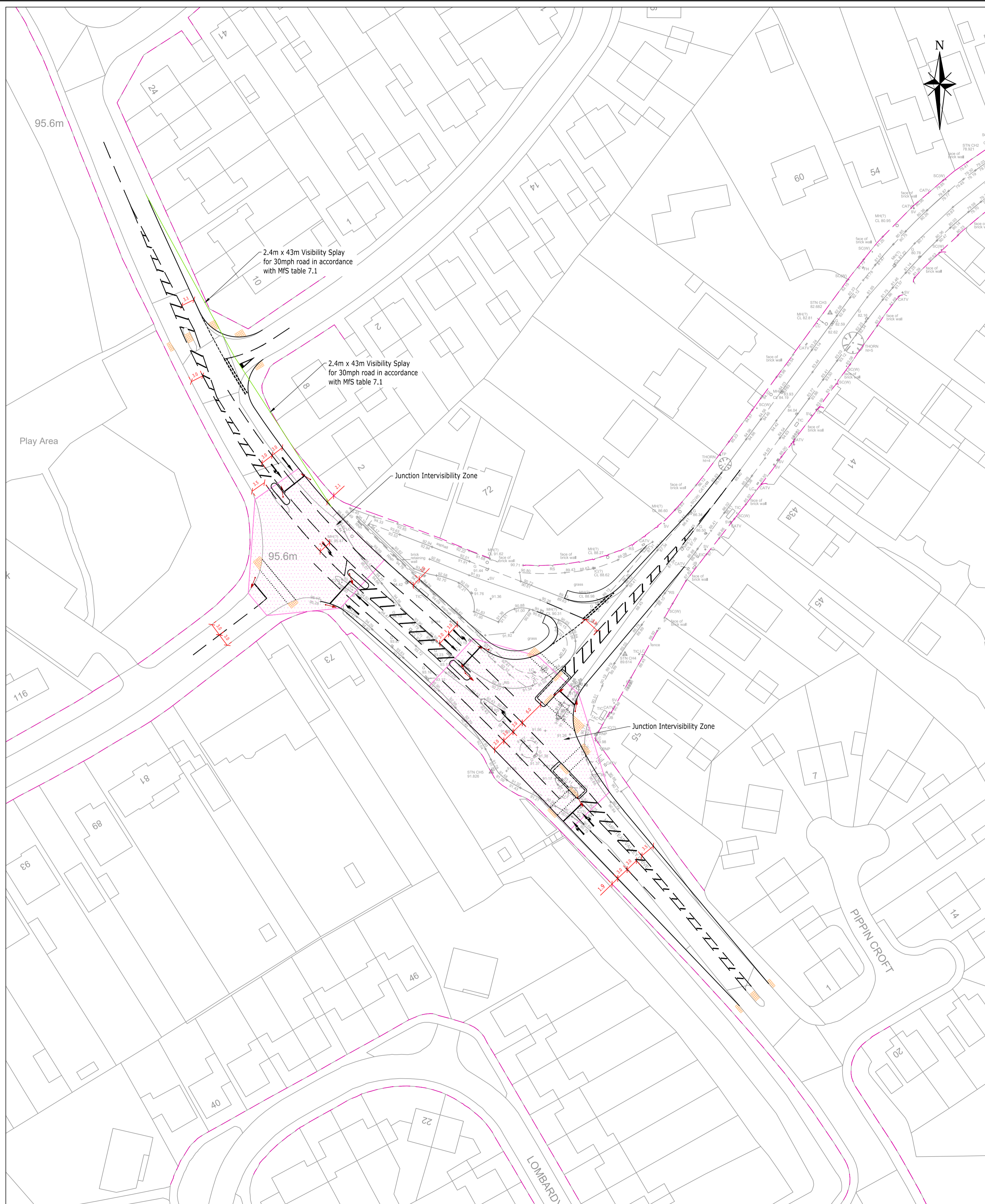

2.4m x 43m Visibility Splay for 30mph road in accordance with MIS table 7.1

2.4m x 43m Visibility Splay for 30mph road in accordance with MIS table 7.1

Junction Intervisibility Zone

Junction Intervisibility Zone



NOTES

--- Highway Boundary

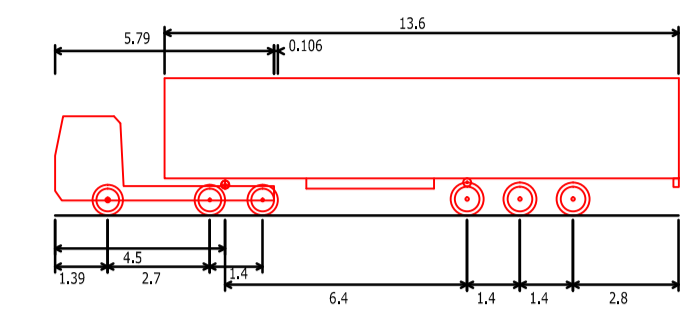

- Max Legal Articulated Vehicle (16.5m)
- Overall Length 16.500m
- Overall Width 2.500m
- Overall Body Height 3.632m
- Min Body Ground Clearance 0.396m
- Max Track Width 2.500m
- Lock to Lock Time 6.00 sec
- Kerb to Kerb Turning Radius 6.870m

DRAFT

Rev	Amendments	Dm	CHK	App	Date

Charles & Associates

Landmark House
Stanton Road
Hampshire
RG27 9HA
01256 436428

Issued by

Park House
Park Farm
East Mallory Trust Estate
Bosborne Lane
Aylesford
Kent
ME20 6SN
01732 448120

enquiries@c-a.co.uk
www.c-a.co.uk

Job Title Hempstead Valley, Medway		
Drawing Title Hempstead Road, Proposed Signalised Junction		
Client K.Attwood		
Scale 1:500 @ A1	Date Mar 19	Designed DH
Drawn DH	Checked SW	Approved JW
Job No 17-035	Drawing No 17-035-020	Rev -

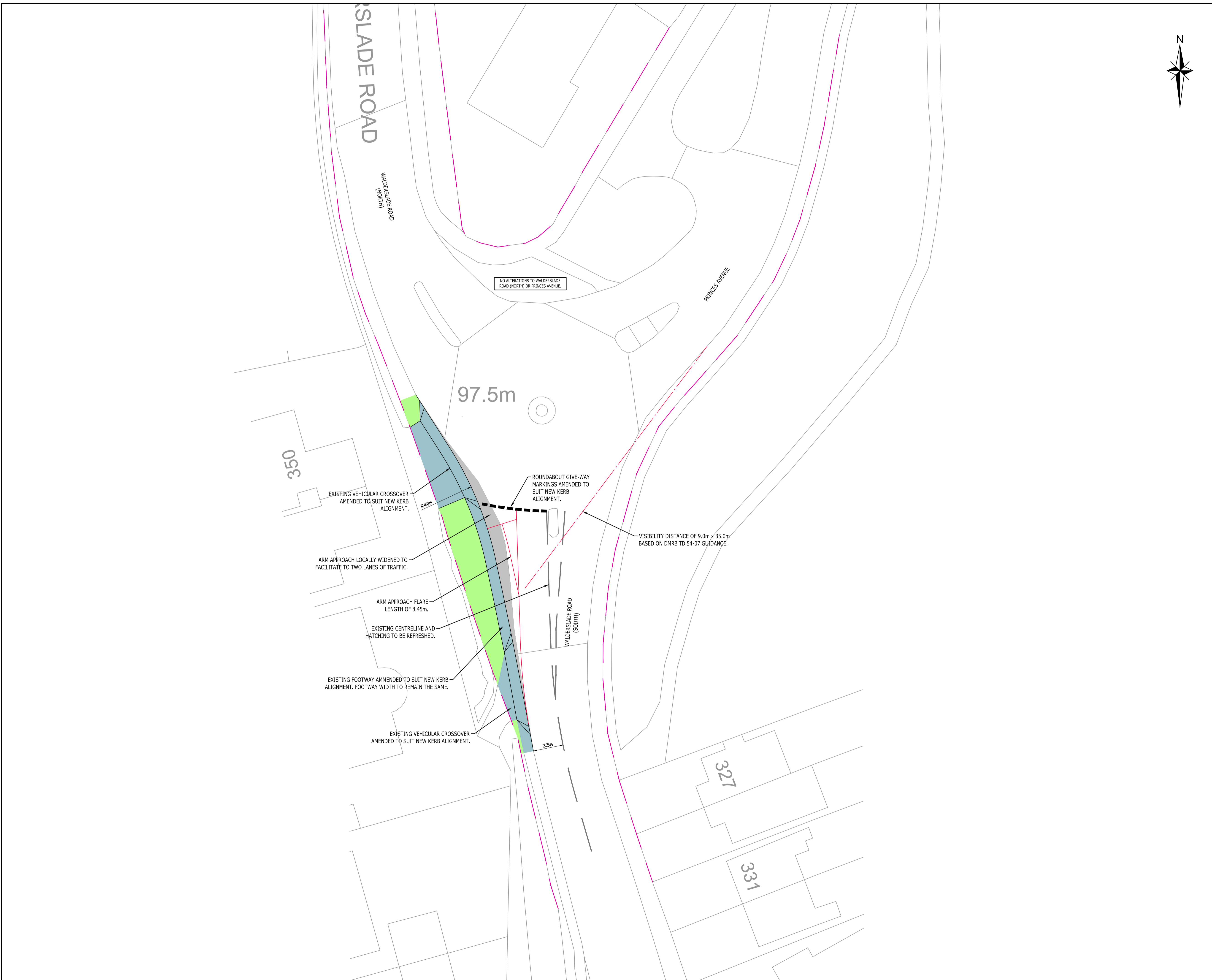

NOTES

- Highway Boundary
- Highway Verge
- Highway Footway
- Highway Carriageway

DRAFT

Rev	Amendments	Dm	Chk	App	Date

Charles & Associates

Issued by

Landmark House, Station Road, Hook, Hampshire RG27 9JL, 01256 436428
 Park House, Park Farm, East Malling Trust Estate, Bawdsey Lane, Aylesford, Kent ME20 6SN, 01732 448120
 enquiries@c-a.uk.com www.c-a.uk.com

Job Title
Hempstead Valley, Medway

Drawing Title
Walderslade Road/Princes Avenue Proposed Roundabout Mitigation

Client
K. Attwood

Scale 1:200 @ A1	Date Mar 19	Designed RA
Drawn RA	Checked SW	Approved JW
Job No 17-035	Drawing No 17-035-021	Rev -



NOTES

- Highway Boundary
- Highway Verge
- Highway Footway
- Highway Carriageway

DRAFT

Rev	Amendments	Dm	Chk	App	Date

Charles & Associates

Issued by: Park House
Park Farm
East Mallard Trust Estate
Boscombe Lane
Aylesford
Kent
ME20 6SN
01732 448120

Landmark House
Station Road
Hampshire
RG27 9HA
01256 426426

enquiries@c-a.co.uk
www.c-a.co.uk

**Hempstead Valley,
Medway**

**St End Rd/Capstone Rd/Luton High St
Proposed Roundabout Mitigation**

K. Attwood

Scale	Date	Designed	RA
1:200 @ A1	Mar 19	RA	RA
Drawn	Checked	Approved	JW
RA	SW	JW	JW
Job No	Drawing No	Rev	-
17-035	17-035-022	-	-